

1
M-03

**PARTIAL GROUND FLOOR
PROPOSED MECHANICAL LAYOUT**

SCALE 1:100

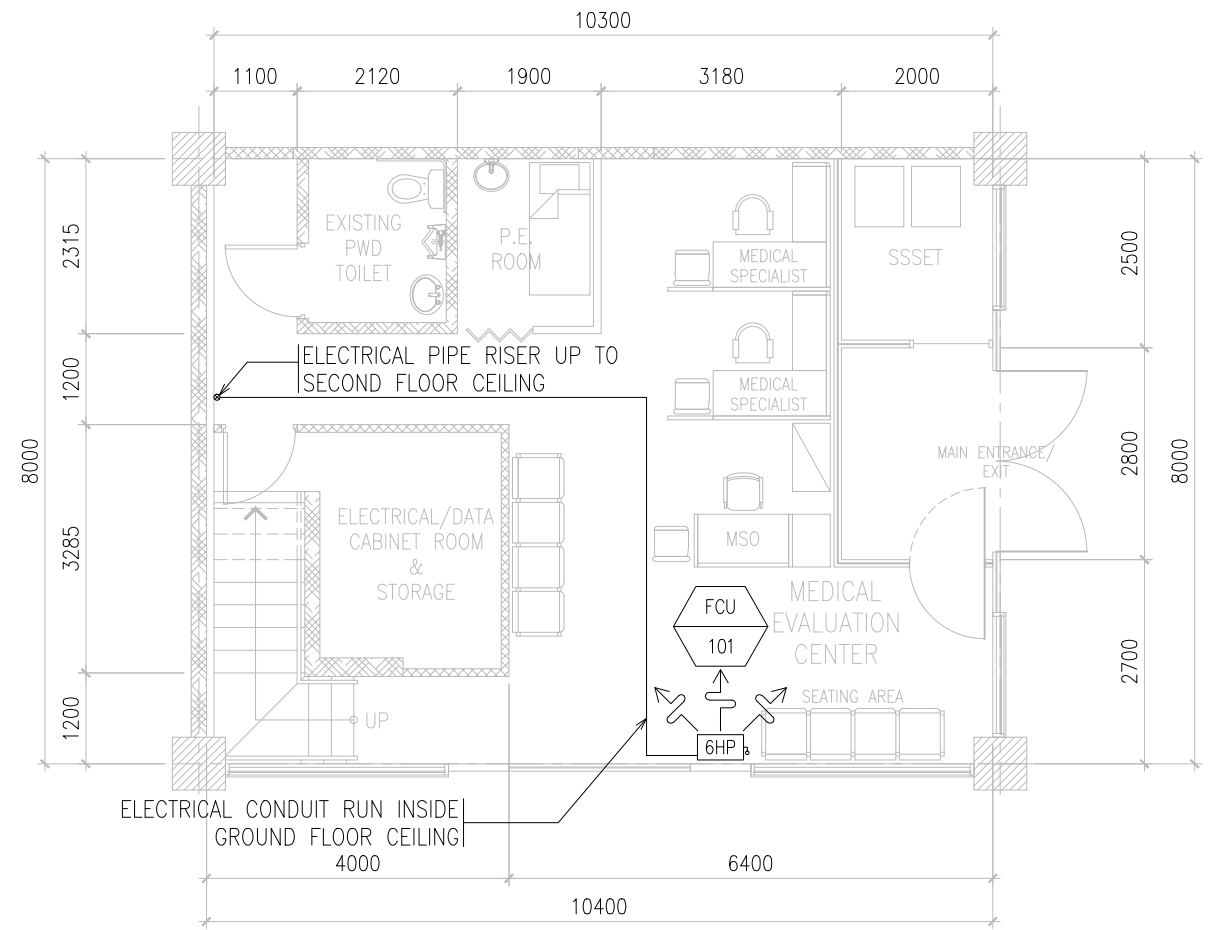

2
M-03

**PARTIAL GROUND FLOOR
PROPOSED A/C ELECTRICAL LAYOUT**

SCALE 1:100



PROJECT TITLE:	PROPOSED RELOCATION OF SSS PASAY - ROXAS BRANCH
LOCATION:	Seascape Village, Atang Dela Rama cor. Zoilo Hilario St., CCP Complex Brgy. 076, Pasay City

RECOMMENDING APPROVAL:	STEPHEN P. YAP ACTING HEAD - EFMD
------------------------	---

APPROVED BY:	HYDEE R. RAQUID ACTING HEAD - GSD
--------------	---

APPROVED AS USER/OWNER:	MARIA RITA S. AGUJA CONCURRENT ACTING HEAD NCR OPERATIONS GROUP
-------------------------	--

APPROVED FOR IMPLEMENTATION:	JOHNSY L. MANGUNDAYAO ACTING HEAD - ADMINISTRATION GROUP
------------------------------	--

ENGINEERING TEAM
DESIGNED & DRAWN BY: Antonio V. Trinos, Jr - Sr. Engr, EMT-1
REVIEWED & CHECKED BY: George N. Carreon - SSO V, EMT - 1

SHEET CONTENT:
PARTIAL GROUND FLOOR PROPOSED MECHANICAL LAYOUT PARTIAL GROUND FLOOR PROPOSED A/C ELECTRICAL LAYOUT

ALL DRAWINGS MUST BE VERIFIED ON SITE BY THE CONTRACTOR. ALL DISCREPANCIES SHOULD BE REPORTED IMMEDIATELY TO THE ARCHITECT AND PROJECT MANAGERS.
CONTRACTORS ARE TO PREPARE AND SUBMIT SHOP DRAWINGS TO THE ARCHITECT PRIOR TO COMMENCEMENT OF WORKS.

SHEET NO.	M-03
DATE:	April 22, 2021